



- 60' x 16' Monticello River Yacht®**
- 60' x 17'6" Monticello River Yacht®**
- 70' x 16' Monticello River Yacht®**
- 70' x 17'6" Monticello River Yacht®**
- 60' x 18' Monticello River Yacht®**
- 70' x 18' Monticello River Yacht®**



70' X 17'6" Monticello River Yacht shown in picture



KENTUCKIANA YACHT SALES, INC.

700 E. Market Street, Jeffersonville, Indiana 47130
P.O. Box 1585, Jeffersonville, Indiana 47131-1585
PH: (812) 282-7579 FAX: (812) 282-8020
Web: www.kys.com E-mail: fun@kys.com



60' x 16' Monticello River Yacht®
60' x 17'6" Monticello River Yacht®
70' x 16' Monticello River Yacht®
70' x 17'6" Monticello River Yacht®
60' x 18' Monticello River Yacht®
70' x 18' Monticello River Yacht®

Standard Equipment List

Propulsion

Twin Gas Engine - Mercruiser 8.1 Liter MPI (370hp) V-drive
(2) Fuel Tanks (240 gal each) - Transfer on both engine & gen
Mercury Marine *Vessel View* Digital Monitoring System
Fuel System Shutoff Valves
Vernay Mufflers
(3) Perko Water Strainers - Engines & Gen
PWC Refueling Station - Gas Boats Only with key switch
Rudder Indicator - Mercury Marine - Dual Helm
in *Vessel View*
Dual Station Shifters - Mercury DTS Electronic
Dual Station Steering - Hydraulic Capilano by Teleflex
Stainless Steel Prop Shafts and Rudders
Nibral 4-blade Props - 22x18 Cupped
Magnesium Zincs - on Prop Shafts, Rudders & Transom

Generator

14.0 KW Westerbeke (Gasoline) Safe - Co

Hull, Deck & Stringer Systems

Deep River Yacht Hull - Full V-Shape
8" Center "V" Keel
High Bow and High Freeboard
4/16" Marine Grade 5052 Aluminum - All Areas
(3) Individually Sealed Bulkhead Compartments
--Engine Room, Cabin & Bow
Hull Paint Between Water Line and Deck
Underwater Tar Epoxy From Boot Stripe to Below Chine
Egg Crate Style Stringer System
w/ Athwartship Stringers on 12" Centers

Structural Accessories

Cleats - Located on Front Deck (2),
Rear Deck (2), and side locations (2)
Fully Covered Aft Deck with White Aluminum Soffit
Partially Covered front deck with White Aluminum Soffit
All Hatch lids with Gas Assisted Cylinder Shocks
Front Deck Hatch Access to Bow
Gutter Rail System (Top Deck)
and Fiberglass Supports on Aft Deck
Handrail - 1 5/8" Upper and Lower Rails Brushed Anodized
Handrail - Lower and Upper Rails Covered
with Canvas or DiBond (not all rails)
Insulation - Interior Ceiling with R-19 6" Batten
Insulation - Insulated Walls
Insulation - Thermopane Vinyl Sliding Doors & Windows
Dibond gate on swim platform

Structural Accessories (cont.)

Rail Gates at Front Deck Side Entrances and Aft Deck Entrances
10' Front sliding door
Roof Mounted Davit System with 1000lb Cap. 120 Volt Winch
Rub Rail - Large (Around Hull)
Non-skid finish on top deck
Staircase - Aft Deck Fiberglass Spiral with Carpeted Steps
Storage - Aft Deck Fiberglass Locker w/ Locking Handle
Storage - Below Cabin Main Deck Floored w/ 110VAC Lighting
Swim Ladder (Stow-A-Way)
(2) Swim Platform Standoffs - Removable
Windlass Anchor System in Bow w/ Remote Control at Lower Helm
Custom fiberglass front ends with radiused windows

Climate Control System (Heat Pump)

2.5 ton Central Heat and Air Conditioning System
with 5KW Electric Heat Strips

Electrical Accessories

35A 3-Bank Battery Charger for Engine Compartment
(3) Batteries - For Engines and Generator with manual crossover
switch at helm
(1) Battery - for Windlass/House
Battery isolator to charge house battery
Breaker Panels - 220VAC/110VAC/12VDC
Cable TV inlet with television outlets
Corrosion Monitor System
Fan - Weatherproof 52" on Aft Deck
(2) Fans - Exhaust in bathroom
(4) Halogen Spreader Lights in Roof - Fwd & Aft Corners
Isolation transformer on Each Shore Cord
Lighting - Exterior front and aft deck Lighting - (3) 110VAC / (3) 12DC each
Lighting - Rope Lights - all around
Lighting - 110VAC Incandescent Can Lights on Dimmer
Lighting - 12VDC Halogen
Lighting - Halogen Counter Lighting in Galley
Outlets - Exterior AC Outlets (GFI) on Front & Rear Decks
Shore Power - 50A / 240VAC with 50' Shore Cord
on Glendenning CableMaster Reel
Shore Power - Secondary 50A/240VAC with 50' Shore Cord
Television outlets
Telephone inlet with telephone outlets
Wiring - Double Insulated Boat Cable
Wiring - Pre-Wired for Satellite TV
Wiring - Pre-Wired for Inverter
Wiring - Pre-Wired for TV antenna



60' x 16' Monticello River Yacht®
60' x 17'6" Monticello River Yacht®
70' x 16' Monticello River Yacht®
70' x 17'6" Monticello River Yacht®
60' x 18' Monticello River Yacht®
70' x 18' Monticello River Yacht®

Electronic Accessories

Speakers - Ceiling Mounts with Individual Room Volume
Controls (Front Deck, Rear Deck, Guest SR, Master SR)
Stereo System - Salon - Surround Sound System with DVD Player
Stereo System - AM/FM/CD Changer
Television - 42" Flat Panel LCD in Salon Entertainment Center
Television - 20" Flat Panel LCD with DVD in Master SR

Lower Helm Station

Backup Camera / Monitor System (Color Camera)
Vessel View Digital Display with GPS (Speed), Depth,
and Smartcraft Info
Searchlight with wireless remote
Rudder Angle Indicator in Vessel View
VHF Radio with 8' Fiberglass Antenna Mounded on Bridge Arch
Windlass Control Panel

Bridge Station

5 Piece Lounger with Bimini Top, Bridge Chair, Vinyl Cushions
Cover, Radar Arch, Lighting, & Ergonomic Winshield
Vessel View Digital Display with GPS(Speed), Depth, & Smartcraft Info
Backup Camera / Monitor System (Single color camera)
Remote Control Searchlight
Rudder Angle Indicator in Vessel View
Stereo - AM / FM / CD with (4) Speakers
VHF Radio Remote

Plumbing

Aft Deck Shower (H/C) on Swim Platform
(3) Bilge Pumps (Automatic with Manual Back-up)
Dockside Water Hookup (Fresh Water) with
Pressure Regulated Water Inlet
(2) Heads - TECMA - with Fresh Water Flush
Holding Tank, 78 Gallon
Level Monitoring System - Water & Waste Levels
in Vessel View
Water Heater - 20 Gallon Electric (40 gallon on 70' X 18')
Water Pump - 12VDC Pressurized
Water Tanks - 240 Gallons
Winterization Valve Systems - Exterior Fresh Water

Appliances

Central Vacuum System with Tool Kit, Electric Power Head,
Electric House and (2) inlets
Dishwasher - 24"
Garbage Disposal
Microwave - Range Hood - 30" - Vented Outside
Oven & Range - 30" Electric - Ceran Smooth Top -220Volt
Refrigerator - 25cf with Thru Door Ice and Water
Trash Compactor - 15"
Washer / Dryer - 24" Stack Unit - 220 Volt
Black Finish on Appliances

Furniture

Bar Stools
Helm Chair
Sofa and Recliner
Table - with Chairs

Interior

Bath - 48" Sit down with glass door
Bath - Vanity with Hi-Macs Solid Surface Top (2)
Bath - Deluxe Fiberglass Shower with
Metal / Glass Door in Guest Bath
Bath - Lighted Mirror (2)
Cabinets - Deluxe Solid Wood with Raised Panel Doors
and Brushed Nickel Hardware (2)
Carpet - Choice of Plush or Berber
Ceilings - Textured Vinyl
Ceramic Tile in Galley and Heads
Countertops - Hi-Macs Solid Surface
Custom Bedspreads or Bed Caps with Shams
Custom Entertainment Center
Custom Inside Spiral Stairs with Insulated Roof Access Hatch
Deluxe Solid Wood Trim
Designer Helm Station with Burl Laminate & Teak Steering Wheel
Dinette Picture Window - 5' x 5' with 'T' Slider
Doors - Solid Wood 6-panel
Draperies - Custom Made with Black-out Lining
Drop Soffit in Galley - Includes Can Lights
and Rope Lights on Dimmers
Galley - stainless sink with high rise faucet
Mattresses - Queen Pillowtop Orthopedic in Staterooms
Mattresses - Regular Queen in forward Cuddy (60' only)
Paneling - Premium 1/4" Wood
Pillows - (2) Large Décor Sofa Pillows
Pillows - (3 per bed) Custom Mixed Décor
Windows - White Aluminum with Screens
and Thermopane Tinted Glass
Window Treatments - Padded Valances with Drapes or Blinds

Exterior

Carpet - Indoor / Outdoor on front/rear decks
Custom vinyl striping package

Safety Accessories

Automatic Engine Room Fire Extinguisher System
Boat Hook
(3) Carbon Monoxide Detectors
(6) Dock Rope - 5/8"
(4) Fenders - Large Inflatable
(3) Fire Extinguishers
(8) Life Jackets
Ring Buoy - 24" with Line
Ship's Bell - 8" Chrome

16' x 70' Monticello River Yacht®

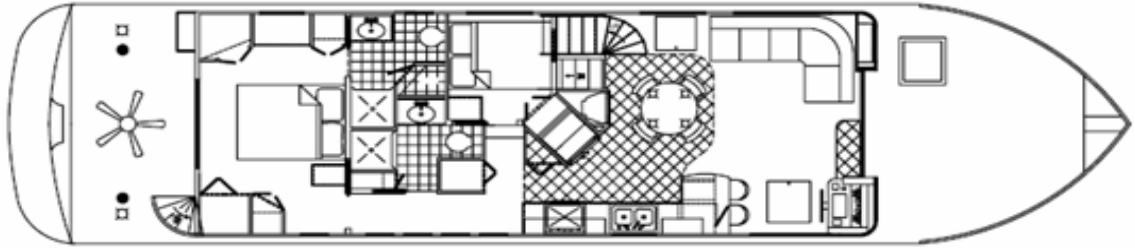

One Lower Queen Bed Not Shown

| | | | |
|-------------------------------|---------|------------------------|-------------|
| Length Overall: | 70' | Weight (approx): | 39,000lbs |
| Beam: | 16' | Cabin Length: | 42' |
| Avg. forward freeboard at bow | 6'3" | Cabin Width: | 15' |
| Catwalks: | 6" | Cabin height interior: | 7'3" |
| Draft: | 38" | Fwd deck length: | 16' |
| Fuel Capacity (approx): | 480 gal | Holding capacity: | 78 gal each |
| Water capacity (approx): | 240 gal | | |

17'6" x 70' Monticello River Yacht®

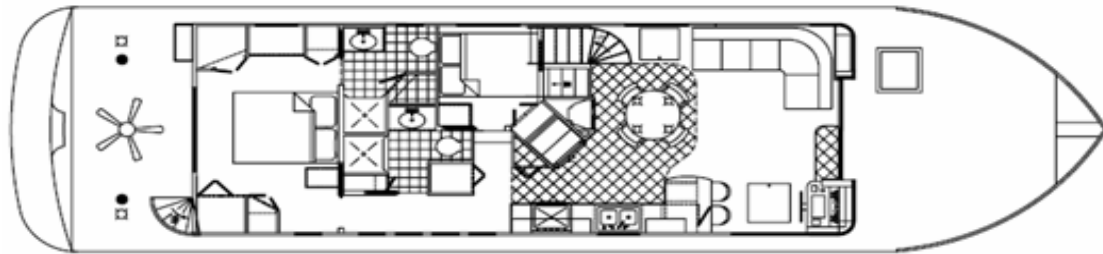

One Lower Queen Bed Not Shown

| | | | |
|-------------------------------|---------|------------------------|-------------|
| Length Overall: | 70' | Weight (approx): | 44,000lbs |
| Beam: | 17'6" | Cabin Length: | 42' |
| Avg. forward freeboard at bow | 6'3" | Cabin Width: | 15' |
| Catwalks: | 14" | Cabin height interior: | 7'3" |
| Draft: | 38" | Fwd deck length: | 16' |
| Fuel Capacity (approx): | 480 gal | Holding capacity: | 78 gal each |
| Water capacity (approx): | 240 gal | | |

17'6" x 70' Monticello River Yacht®

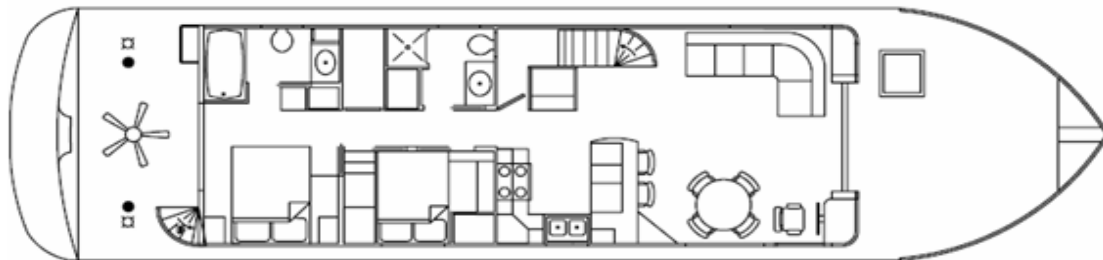

Two Lower Queen Beds Not Shown

*Floorplan is also available in 16' x 70' without Catwalks

| | | | |
|-------------------------------|---------|------------------------|-------------|
| Length Overall: | 70' | Weight (approx): | 44,000lbs |
| Beam: | 17'6" | Cabin Length: | 42' |
| Avg. forward freeboard at bow | 6'3" | Cabin Width: | 15' |
| Catwalks: | 14" | Cabin height interior: | 7'3" |
| Draft: | 38" | Fwd deck length: | 16' |
| Fuel Capacity (approx): | 480 gal | Holding capacity: | 78 gal each |
| Water capacity (approx): | 240 gal | | |

16' x 60' Monticello River Yacht®

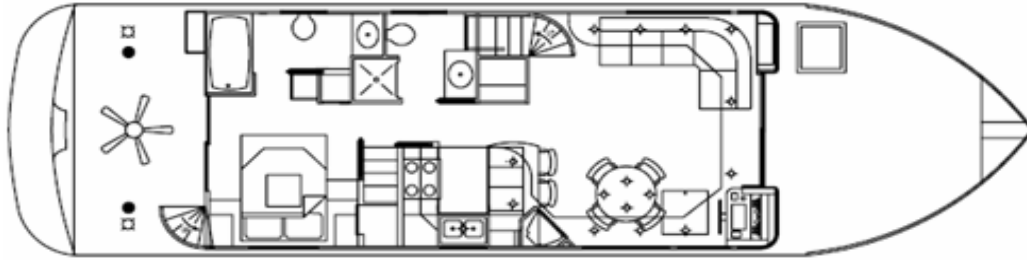

Two Lower Queen Beds Not Shown

*Floorplan is also available in 17'6" x 60' without Catwalks

| | | | |
|-------------------------------|---------|------------------------|-------------|
| Length Overall: | 60' | Weight (approx): | 35,000lbs |
| Beam: | 16' | Cabin Length: | 33'6" |
| Avg. forward freeboard at bow | 6'3" | Cabin Width: | 15' |
| Catwalks: | 6" | Cabin height interior: | 7'3" |
| Draft: | 38" | Fwd deck length: | 15' |
| Fuel Capacity (approx): | 480 gal | Holding capacity: | 78 gal each |
| Water capacity (approx): | 240 gal | | |

18' x 60' Monticello River Yacht®

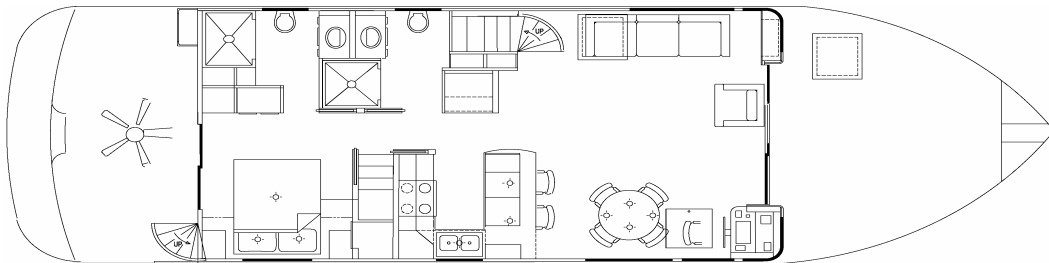

Two Lower Queen Beds Not Shown

| | | | |
|-------------------------------|---------|------------------------|-----------|
| Length Overall: | 60' | Weight (approx): | 37,000lbs |
| Beam: | 18' | Cabin Length: | 33'6" |
| Avg. forward freeboard at bow | 6'3" | Cabin Width: | 15' |
| Catwalks: | 14" | Cabin height interior: | 7'3" |
| Draft: | 38" | Fwd deck length: | 15' |
| Fuel Capacity (approx): | 480 gal | Holding capacity: | 78 gallon |
| Water capacity (approx): | 240 gal | | |

18' x 70' Monticello River Yacht®

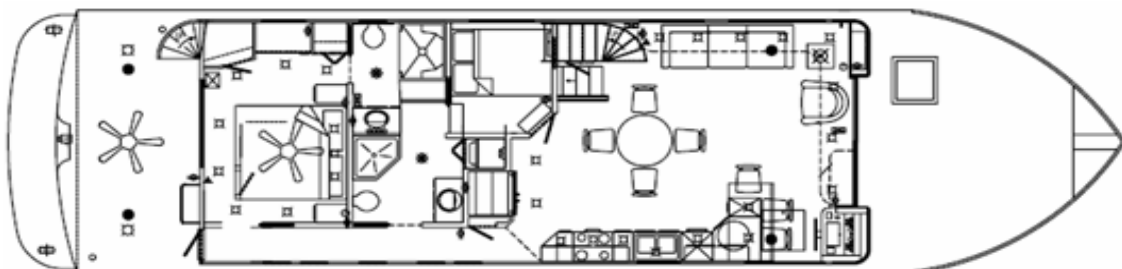

One Lower Queen Bed Not Shown

| | | | |
|-------------------------------|---------|------------------------|-------------|
| Length Overall: | 70' | Weight (approx): | 45,000lbs |
| Beam: | 18' | Cabin Length: | 42' |
| Avg. forward freeboard at bow | 6'3" | Cabin Width: | 17' |
| Catwalks: | 6" | Cabin height interior: | 7'3" |
| Draft: | 38" | Fwd deck length: | 16' |
| Fuel Capacity (approx): | 480 gal | Holding capacity: | 78 gal each |
| Water capacity (approx): | 240 gal | | |

**Majestic Yachts, Inc.,
LIMITED WARRANTY**

- 1.) Majestic Yachts, Inc. referred to as the seller, warrants each "Monticello ® River Yacht" to be free from defects in materials and workmanship for a period of (1) year from the date of delivery to location specified in the sales contract.
- 2.) Under this warranty, the obligation of the seller is limited to the replacement or repair of defective parts and corrective repairs of manufacturing defects. The decision as to whether to repair or replace covered components or parts that have become defective within the warranty period shall be at the sole discretion of the seller. The seller may require the covered components or parts to be returned to the factory, at the distributor's or the original purchaser's expense, for examination to determine warranty coverage eligibility.
- 3.) This warranty does not apply to any of the following items:

| | |
|--|-------------------|
| Normal wear and tear | Routine servicing |
| Damage caused by negligence, misuse, or modification | Engine |
| Generators | Air Conditioners |
| Major Appliances | Paint |
| Chrome/Brass coatings | Deck carpet |
| Discoloration of Fiberglass or Fiberglass parts | Upholstery damage |
| Instruments | |
| Other equipment that is covered by separate manufacturers warranties only. | |
| Any other equipment NOT manufactured by the seller. | |
- 4.) If a boat or part should be or become defective within the warranty period outlined above, prior written approval by the seller in the form of a work order, shall be required before the boat, part, or component will be replaced and or repaired. Should prior approval NOT be obtained before repair or replacement of defective part or component, the seller shall not be liable for the expense of the repair or replacement of defective parts or components.
- 5.) The seller makes no warranty of any type whatsoever to any person other than the distributor or the original purchaser, and the then only as specifically set forth herein. The seller will not be responsible and hereby disclaims any liability for any and all consequential damages, incidental damages, economic damages, damages to property, damages for loss of use, loss of time, loss of profits, loss of income, and any and all other damages of any sort whatsoever.
- 6.) The purchaser will not hold the seller liable for delays in repairs or replacement of part or components caused by manufacturer's accidents, strikes, fires, or any other cause beyond the control of the seller.
- 7.) In the event of legal action regarding this warranty transaction, such action will be adjudicated in Adair County, Kentucky and under the laws of the Commonwealth of Kentucky.
- 8.) The terms and conditions of the limited warranty between the seller and the purchaser contain the entire understanding and no other representation or inducement written or oral has been made.
- 10.) Speeds, fuel consumption and other performance characteristics, because they are estimated, are not guaranteed, and or warranted.

The Seller specifically and expressly disclaims any and all implied warranties including but not limited to an implied warranty of merchantability and/or fitness for a particular purpose. The seller makes no type of warranty with respect to title, security interest, liens, or other encumbrances.